

### Replacement Kits

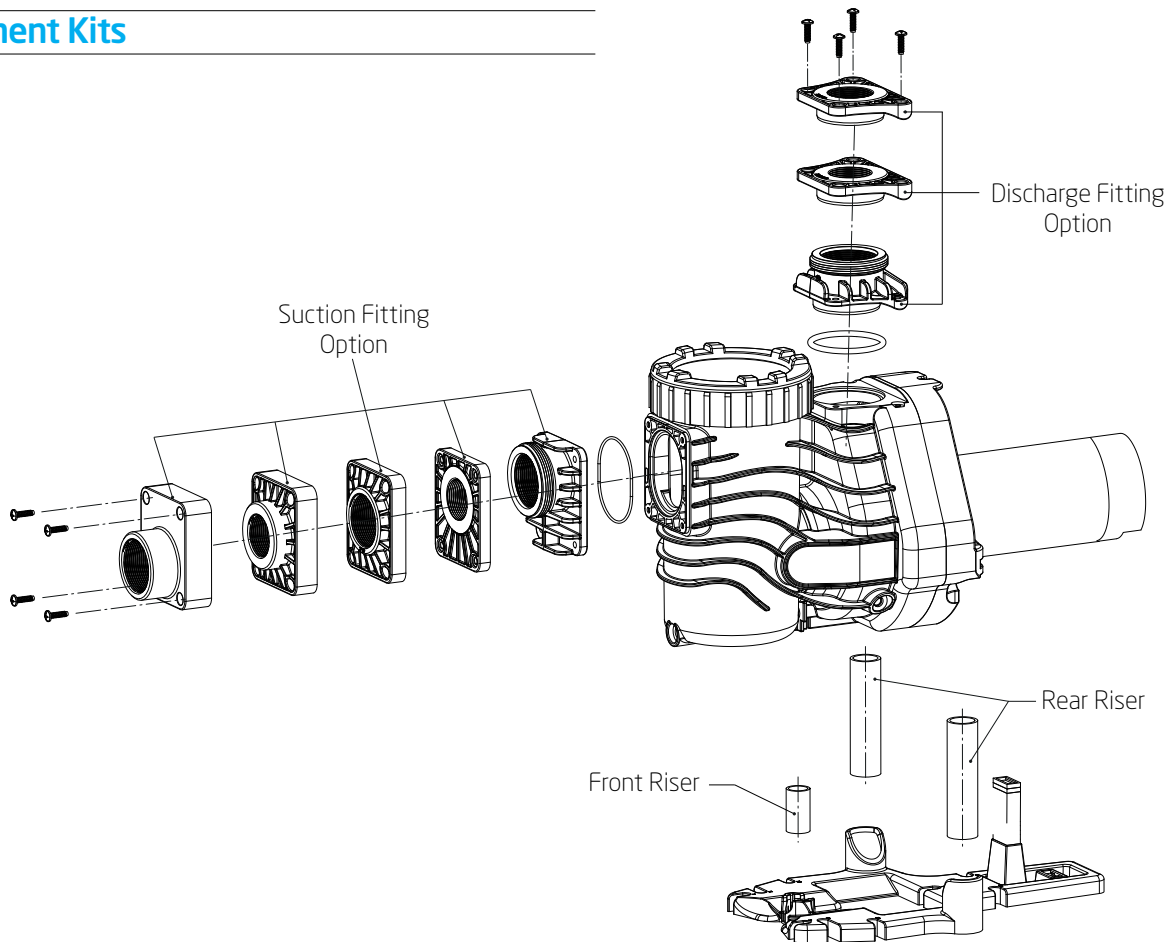

#### Replacement Kits

Order #	Description	List Price
2901410001A	Pentair® <b>Ultra-Flow</b> ® Replacement Kit (2" Fittings & Risers)	\$ 22.10
2901410001B	Pentair® <b>Ultra-Flow</b> ® Replacement Kit (1.5" Fittings & Risers)	22.10
2901410002A	Pentair® <b>WhisperFlo</b> ® & <b>IntelliFlo</b> ® Replacement Kit (2" Fittings)	22.10
2901410002B	Pentair® <b>WhisperFlo</b> ® & <b>IntelliFlo</b> ® Replacement Kit (1.5" Fittings)	22.10
2901410003A	Hayward® <b>Super Pump</b> ® & Pentair® <b>SuperFlo</b> ® Replacement Kit (2" Fittings & Risers)	22.10
2901410003B	Hayward® <b>Super Pump</b> ® & Pentair® <b>SuperFlo</b> ® Replacement Kit (1.5" Fittings & Risers)	22.10
2901410004A	STA-RITE® <b>Dura-Glas</b> & <b>Max-E-Glas</b> ™ Replacement Kit (2" Fittings & Risers)	22.10
2901410004B	STA-RITE® <b>Dura-Glas</b> & <b>Max-E-Glas</b> ™ Replacement Kit (1.5" Fittings & Risers)	22.10
2901410006A	STA-RITE® <b>Dyna-Glas</b> ™ & <b>Dyna-Max</b> ™ Replacement Kit (2" Fittings)	22.10
2901410007A	Pentair® <b>Challenger</b> ® Replacement Kit (2" Fittings & Risers)	22.10
2901410007B	Pentair® <b>Challenger</b> ® Replacement Kit (1.5" Fittings & Risers)	22.10
2901410008A	Hayward® <b>Super II</b> ™ Pump Replacement Kit (2" Fittings & Risers)	22.10
2901410008B	Hayward® <b>Super II</b> ™ Pump Replacement Kit (1.5" Fittings & Risers)	22.10

Hayward® and Super Pump® & Super II™ are trademarks and/or registered trademarks of Hayward Industries, Inc.  
Pentair®, SuperFlo®, WhisperFlo®, IntelliFlo®, Ultra-Flow®, Challenger®, Sta-Rite®, Dyna-Glas™, Dyna-Max™, Dura-Glas, and Max-E-Glas™ are trademarks and/or registered trademarks of Pentair Water Pool and Spa, Inc. and/or its affiliated companies.