

Motor length may vary
provide reserve space for expansion

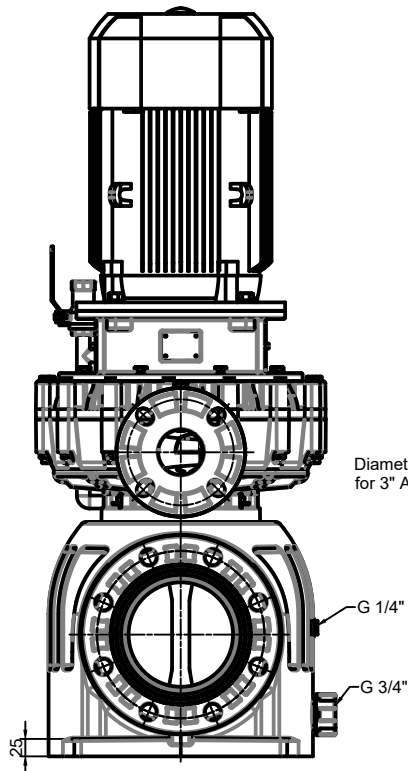
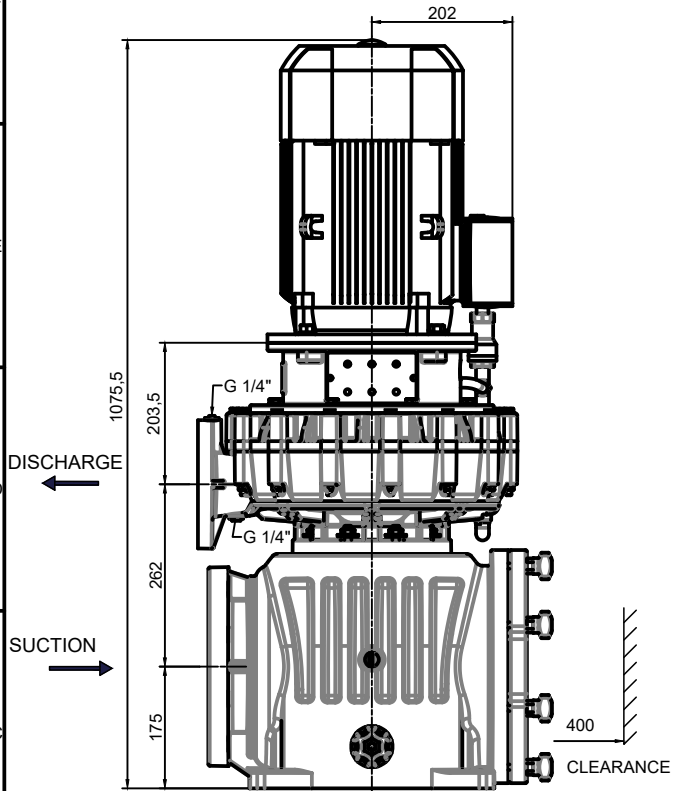

FLANGE CONNECTIONS COMPATIBLE
WITH ANSI CLASS 150 FLANGES

DISCHARGE

SUCTION

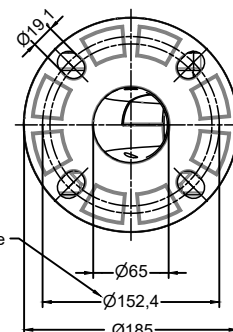

Diameter of Bolt Circle
for 3" ANSI Flange

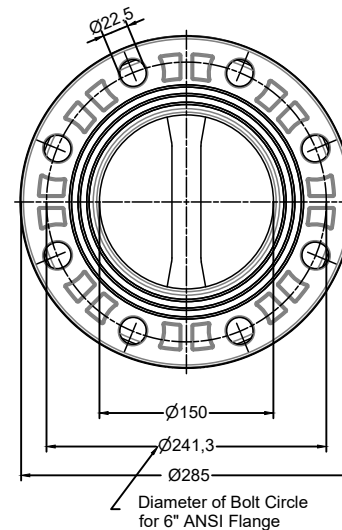

Diameter of Bolt Circle
for 6" ANSI Flange

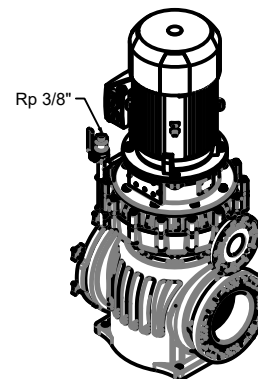

Motor

Frame Size: 132 S
Rating: 5.5 kW
7.5HP SF1.15

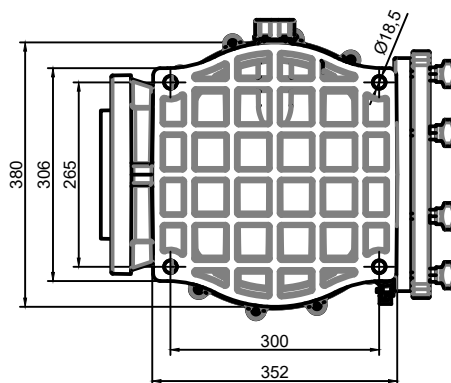
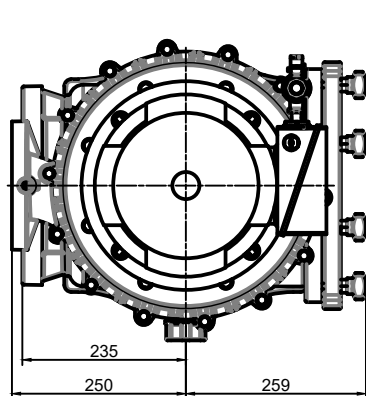

THE INFORMATION CONTAINED HEREIN IS THE PROPERTY OF SPECK PUMPS - POOL PRODUCTS, INC. NO PORTION OF THIS DATA SHALL BE RELEASED, DISC LOADED, USED, OR DUPLICATED FOR USE IN PROCUREMENT OR MANUFACTURING WITHOUT SPECIFIC WRITTEN CONSENT FROM SPECK PUMPS - POOL PRODUCTS, INC.

<p>○ = Reference dimension</p>				<p>Tolerances to: DIN ISO 2768-mS</p>				<p>Scale: Volume:- Weight:-</p>	
<p>Surface</p>				<p>Material:</p>				<p>Part Number:</p>	
<p>1</p>				<p>Revised for SPECK USA 05-13-2016</p>				<p>DIMENSIONAL DRAWING</p>	
<p>Drawn</p>				<p>05-10-2016</p>				<p>BADU Block Multi 65/250 (132S frame motor)</p>	
<p>Checked</p>				<p>Approved</p>				<p>with ASME 6" Suction Flange Connection ASME 3"</p>	
<p>Approved</p>				<p>Approved</p>				<p>Discharge Flange Connection</p>	
<p>SPECK X pumps</p>				<p>8125 Bayberry Road Jacksonville, FL 32226</p>				<p>Drawing Number:</p>	
<p>Rev</p>				<p>Description</p>				<p>VD61.11.012.USA</p>	
<p>Date</p>				<p>Name</p>				<p>1 / 1</p>	
<p>File Name: VD61.11.012.idw</p>				<p>2</p>				<p>A2</p>	